

Harvest Towne Center

4840 Harvest Mill Way
Knoxville, TN 37918

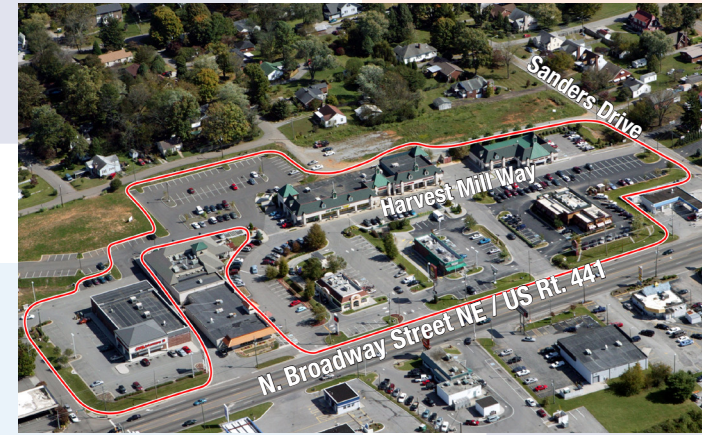

Property Highlights

- Attractive community center anchored by CVS Pharmacy and Pet Supplies Plus; across from Food City and Big Lots
- Located on main commercial thoroughfare and easily accessed from I-640
- Surrounded by dense residential neighborhoods

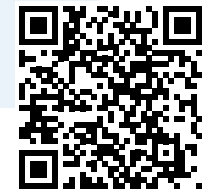

www.rpai.com

For a complete list of RPAI properties, use your QR Reader on your smart phone.

Unit#	Sq. Ft.	Tenant
1	8,120	Pet Supplies Plus
2	986	Available
3	1,670	Regency Finance
4	1,427	Available
5	2,053	Available
6	3,480	Available
8	5,104	Available
9	4,582	Ruby Tuesday
10	2,122	Krispy Kreme
11	2,566	Taco Bell
12	10,125	CVS Pharmacy
13		The Chop House
14		Northside Properties
15		Harvest Town Wine & Spirits

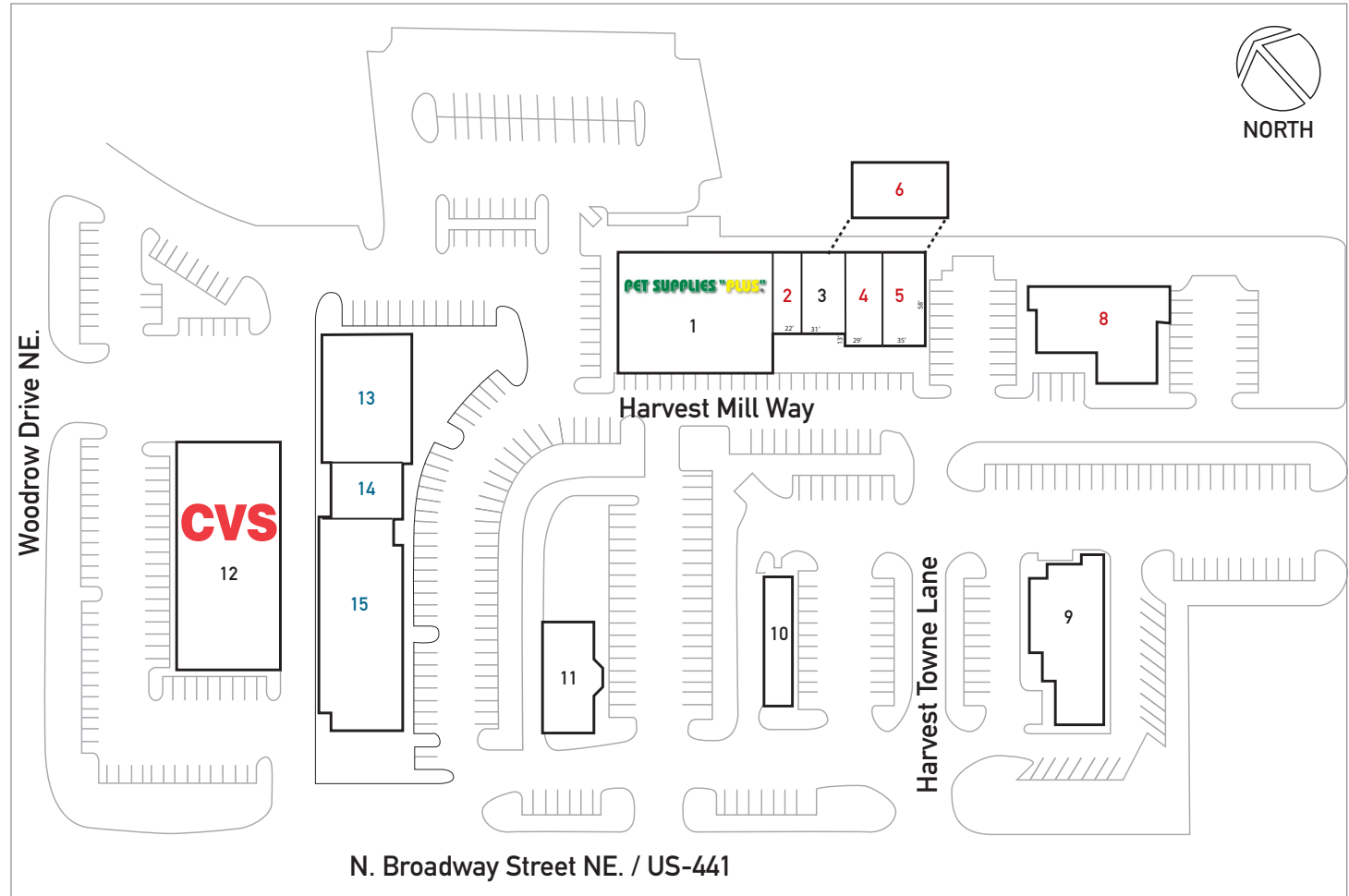

2012 Demographics

	Population	Avg. HH Income	Center Size:
1 Mile	6,498	\$45,681	42,235 Sq. Ft.
3 Mile	55,271	\$44,333	Leasing Contact : Ann Smith
5 Mile	135,922	\$43,070	Ann.Smith@rpai.com 855.646.RPAI

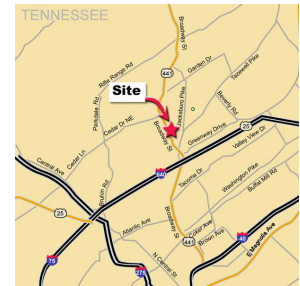

Information given in this presentation is subject to verification and no liability for errors or omissions is assumed.

Items in blue are owned by others.