



NORTHWOOD CROSSING

2300 McFarland Boulevard (US-82), Northport, AL 35476

The Inland name and logo are registered trademarks being used under license

Property Managed by Inland US Management LLC



GLA: 160,259 SF

HIGHLIGHTS

- Anchored by Publix and Office Depot with a diverse mix of tenants including Family Dollar and Wachovia Bank
- Average daily traffic counts include an estimated volume of 73,410 in the streets surrounding the center
- Located near Northport Medical Center and 4 miles from the University of Alabama

2010 TRADE AREA

	<u>5 Minute Drive</u>	<u>10 Minute Drive</u>	<u>15 Minute Drive</u>
Population	25,073	83,775	131,324
Households	9,609	34,594	54,197
Avg HH Income	\$56,469	\$49,202	\$54,078
\$75k + HHs	2,319	6,548	11,995

2015 PROJECTED TRADE AREA

	<u>5 Minute Drive</u>	<u>10 Minute Drive</u>	<u>15 Minute Drive</u>
Population	26,130	87,412	137,582
Households	10,132	36,503	57,397
Est Growth 2010-2015	5.44%	5.52%	5.90%

LEASING • DEVELOPMENT • MANAGEMENT

STORE LISTING

Northwood Crossing
2300 McFarland Boulevard
Northport, AL 35476

Center Size: 160,259 Sq. Ft.

Unit #	Sq. Ft.	Tenant
1	6,400	Family Dollar
2	1,808	Cellular Solution
3	44,271	Publix
4	60,000	Available
5	16,408	Office Depot
6	2,284	Available
7	1,600	Approved Cash Advance
8	1,576	H&R Block
9	2,000	Eagle Cleaners
10	2,000	Citi Financial
11	7,200	Dollar General
12	1,600	Sally Beauty Supply
13	1,600	Nail Studio
14	7,831	Wachovia Bank
15	3,681	McDonald's

NORTHWOOD CROSSING

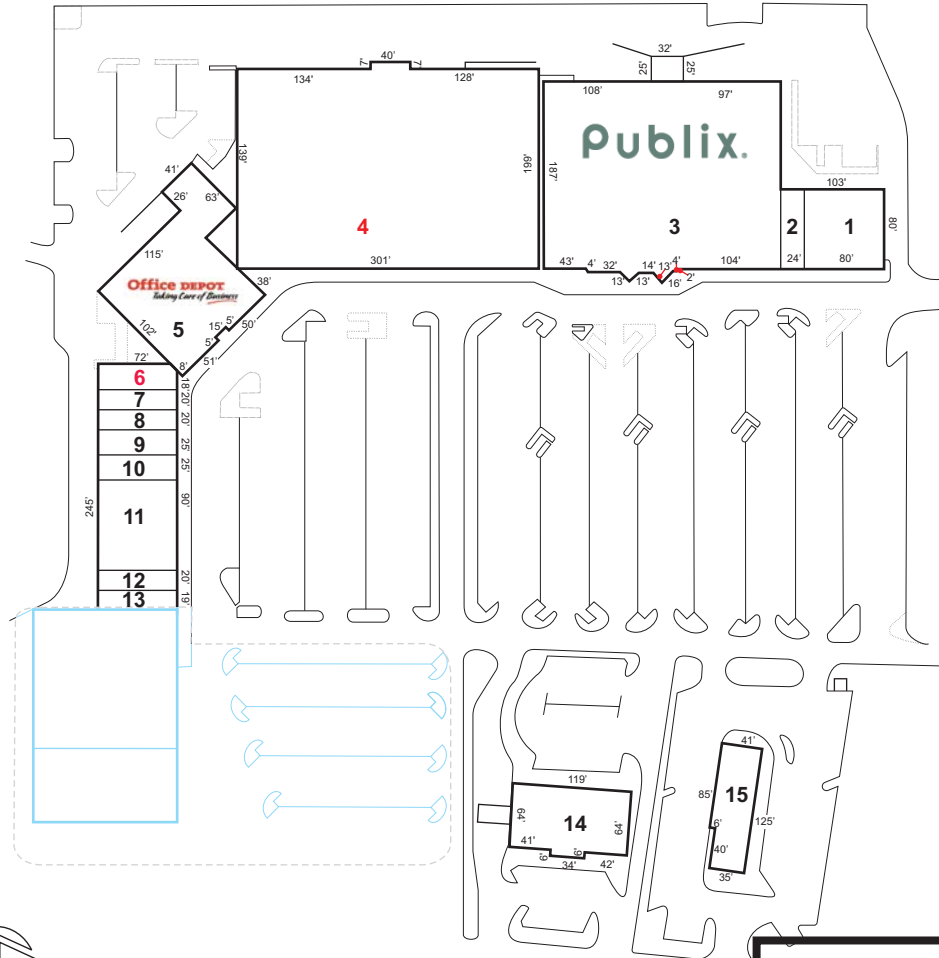

McFarland Boulevard/US Rte. 82

Demographics:	1 Mile	3 Mile	5 Mile
2010 Population	5,891	41,218	83,590
2010 Avg HH Income	\$55,278	\$53,439	\$51,933



Inland US Management LLC
2901 Butterfield Road
Oak Brook, Illinois 60523
www.inland-western.com
866-262-7700

Information given in this presentation is subject to verification and no liability for errors or omissions is assumed.