

Fox Creek Village

1611 Pace Street, Longmont, CO, 80501



INLAND WESTERN

Retail Real Estate Trust, Inc.

4/6/2012

Center Size: 107,533 Sq. Ft.

Unit#	Sq. Ft.	Tenant
1	3,956	King Soopers Fuel Site
2		Outlot Available
3	68,657	King Soopers Grocery Store
4	1,400	Available
5	1,361	H&R Block
6	2,200	Perfect Teeth
7	1,113	Available
8	4,044	At the Beach
10	1,300	Cost Cutters
11	1,300	Art Cleaners
12	1,300	Available
13	1,300	Fossil Spa Nails
14	1,300	Available
16	2,477	Nicolo's Chicago Style Pizza
17	2,584	Available
19	1,398	Baskin Robbins
20	1,400	Available
21	1,500	Starbucks
22	3,415	Wells Fargo Bank
23	3,948	Vino Cellars Wine and Liquor
26	1,580	Subway
27		Walgreens

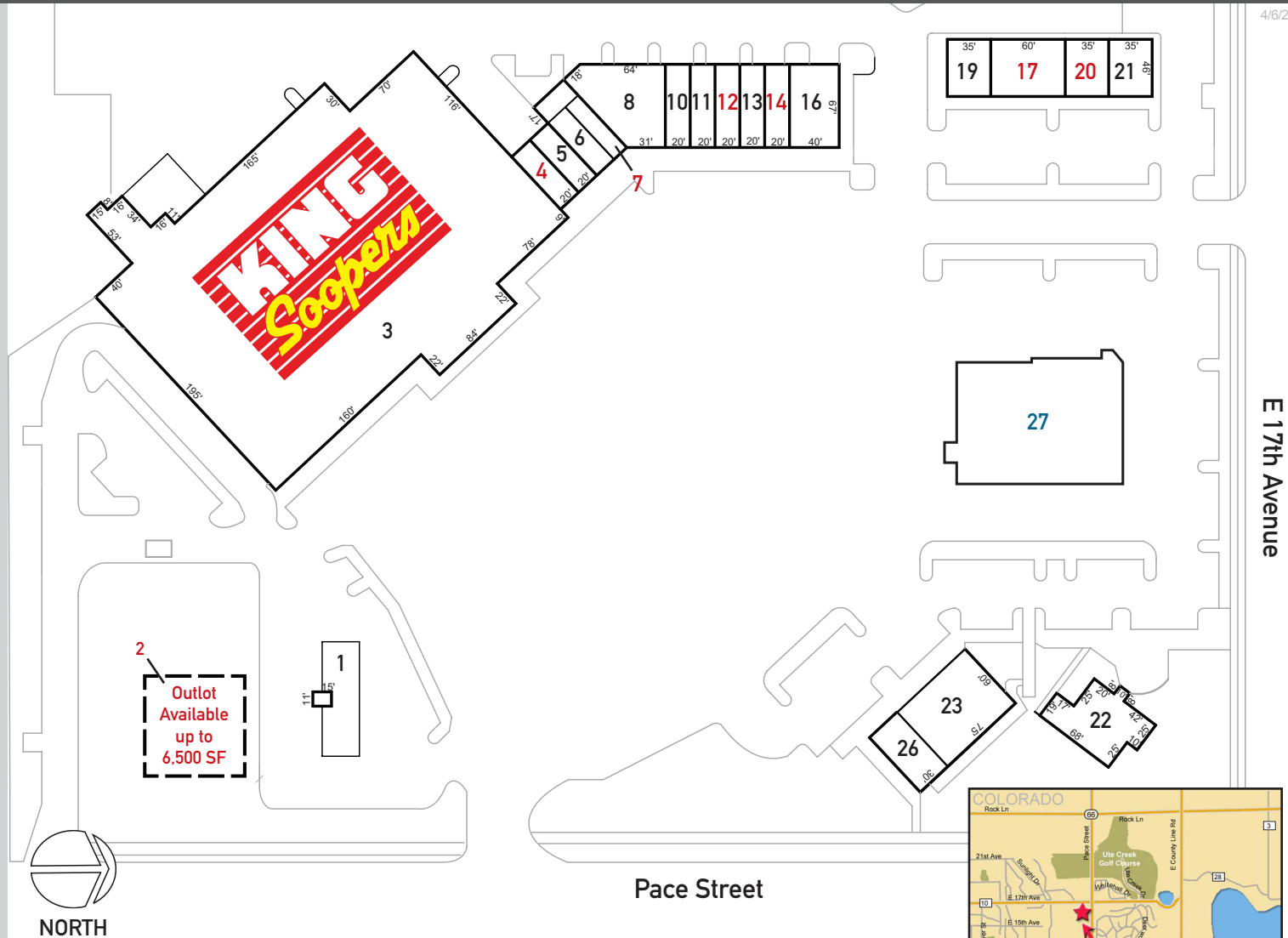

Information given in this presentation is subject to verification and no liability for errors or omissions is assumed.

Items in blue are owned by others.



2012 Demographics

Population	Average HH Income
1 Mile 14,775	1 Mile \$82,039
3 Mile 57,603	3 Mile \$66,327
5 Mile 86,271	5 Mile \$74,953

Property managed by Inland Southwest Management, LLC
The Inland name and logo are registered trademarks being used under license.

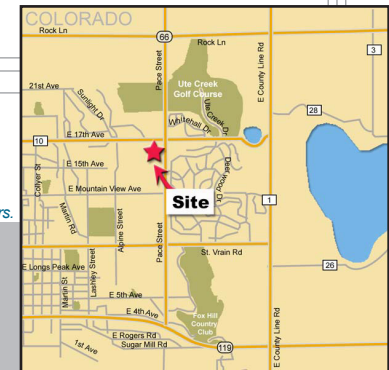

Leasing Contact: **Jed Craig**
jed.craig@inland-western.com • 877.646.5263

www.inland-western.com